

TRACK 48V SYSTEM

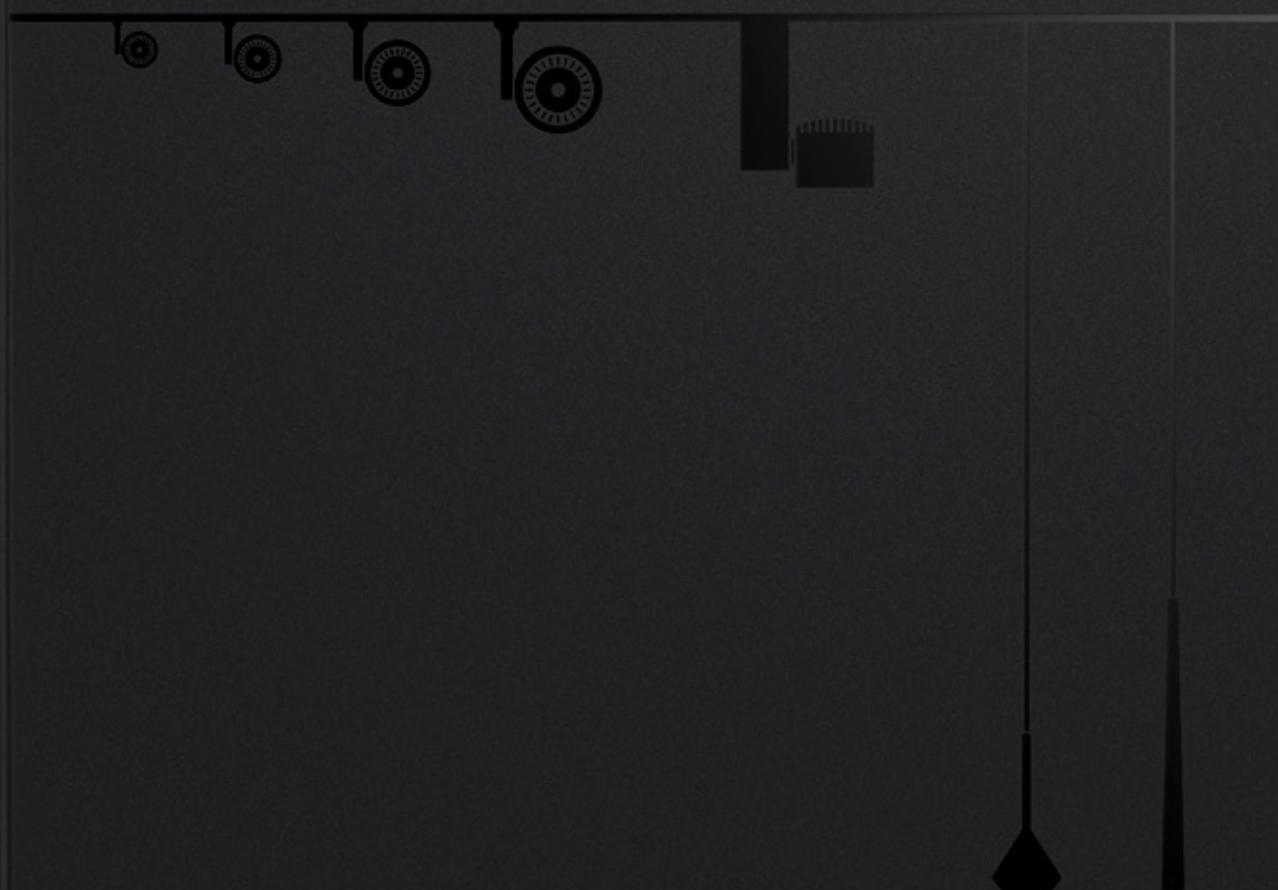

ARKOSLIGHT®

TRACK 48V SYSTEM

TRIMLESS · SURFACE · SURFACE SHORT · SUSPENDED · SUSPENDED SHORT

ARKOSLIGHT®

TRACK 48V

TRACK 48V TRIMLESS

TRACK 48V SURFACE

TRACK 48V SURFACE SHORT

TRACK 48V SUSPENDED

TRACK 48V SUSPENDED SHORT





“Track 48V Surface” y “Track 48V Surface Short”
dos alturas de carril, dos gamas de producto compatible.

Amplia colección de producto. Un sistema, múltiples
soluciones lumínicas.

Miniaturización y minimalismo formal: máxima integración
en la arquitectura.

Seguridad eléctrica, bajo voltaje.

Facilidad de instalación, sin necesidad de herramientas.

Versátil: cambios de ubicación simples y manuales.

Calidad percibida máxima en detalles y acabados.

Compatible con sistemas de control DALI.



MENOR TAMAÑO, MEJOR INTEGRACIÓN

Las dimensiones del track 48V permiten una integración perfecta de la iluminación en el espacio arquitectónico. La versión 'trimless' se muestra como una estrecha línea minimalista, mientras que las variantes de superficie y suspensión presentan un aspecto sobrio y discreto.

La variante 'short' ha sido diseñada para conseguir una notoria miniaturización y ofrecer, una vez instalada, un aspecto visual de integración que reduce la presencia del carril a la mínima expresión.

SEGURIDAD ELÉCTRICA

La baja tensión del carril es sinónimo de seguridad eléctrica para el usuario y permite una mayor versatilidad y facilidad de uso e instalación. Las luminarias pueden colocarse sin necesidad de desconectar el carril de la corriente y ser manipuladas directamente con las manos, sin medios de protección.

Esta ventaja existe porque la baja tensión del carril 48V es inferior al límite a partir del cual el contacto con la electricidad es dañino para el ser humano. El rendimiento de la mejor iluminación técnica, con cero riesgos.

FACILIDAD DE INSTALACIÓN

Pocas cosas hay más sencillas que instalar una luminaria en un carril de bajo voltaje de Arkoslight.

Sin necesidad de herramientas, sólo con las manos y con una suave presión, el sistema de clipaje del producto se fija en el carril y queda instalado y alimentado eléctricamente. Nada más fácil.

Además, tan asequible como su instalación es cambiar el producto de emplazamiento. Sólo se retira de su posición con una leve tracción y se vuelve a aplicar del mismo modo que fue instalado, tantas veces como se desee.





PUREZA Y ELEGANCIA

La pulcritud formal de los carriles 48V, junto a la sobriedad elegante y minimalista de las luminarias para este sistema, resulta en un conjunto de exquisita expresión: simple, racional y de alta calidad percibida.

El cuidado detalle de los acabados se evidencia en cada pieza de este sistema de bajo voltaje, donde la miniaturización obliga a prestar especial mimo a los aspectos más minúsculos de la construcción de cada carril y luminaria.

CONTROL DALI

Los carriles 48V de Arkoslight son compatibles con el sistema de control DALI, que permite la comunicación bidireccional entre el dispositivo de control y las luminarias y abre la posibilidad al usuario de crear escenas, gobernar el sistema desde dispositivos de control DALI, etc...

A través de sistemas de control DALI y sus variantes inalámbricas ARK-Control, el usuario adquiere el manejo total de su instalación, con todas las prestaciones disponibles en las alternativas de alto voltaje. El sistema 48V no significa renunciar a la vanguardia en control para la iluminación arquitectónica.

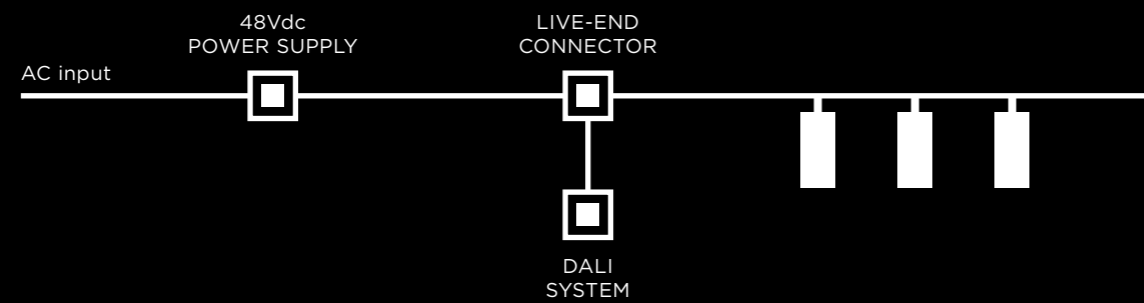

Casa Cruz | Design: Rubén Muedra Estudio de Arquitectura | Photography: Adrián Mora Maroto



VERSATILIDAD

El carril de bajo voltaje permite cubrir todas las necesidades lumínicas de un proyecto, al tiempo que es capaz de adaptarse a los cambios que puedan suceder en la escena.

No importa cuál sea la necesidad del proyecto: acento, proyección, ambiente... cualquier efecto lumínico es posible con alguna de las soluciones disponibles para este sistema de bajo voltaje de Arkoslight.

Las posibilidades de escenas y configuraciones son casi infinitas.

TRACK 48V SURFACE



TRACK 48V SURFACE SHORT



UNA VARIANTE PARA CADA ALTO DE CARRIL

El sistema Track 48V de Arkoslight tiene dos alturas de carril, de 54mm y 29mm. Para proyectos donde prima la mínima expresión de la iluminación, existen variantes de producto que han sido especialmente diseñadas para adaptarse al carril 'Short'.

Gympact (Belgium) | Design: Salvator Store | Photography: Annelies Degroote





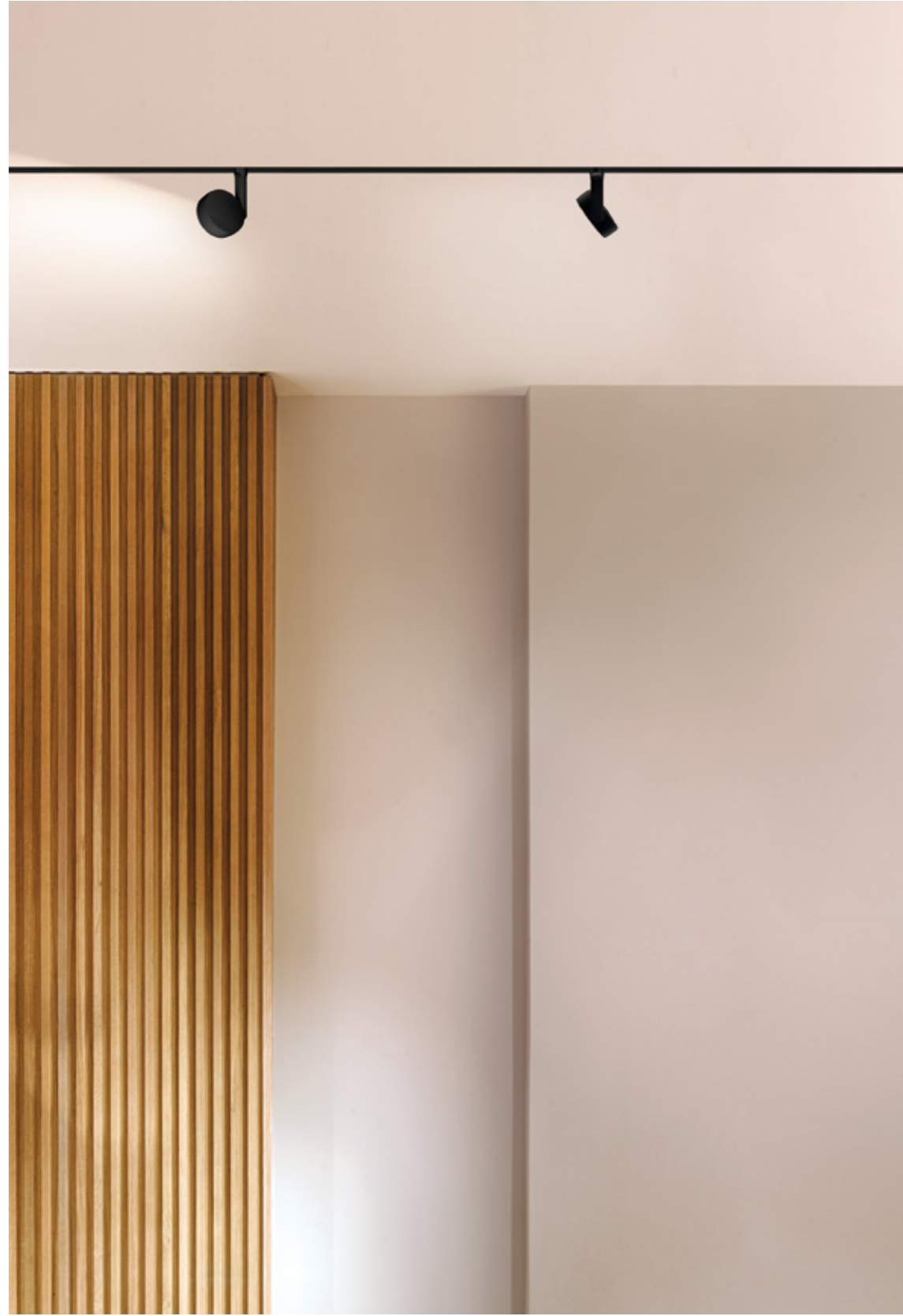

Bang & Olufsen Shop, Valencia (Spain) | Design: Alfredo Menzó | Photography: Héctor Rubio - Images Positive

TRACK 48V ESPECIFICACIONES TÉCNICAS

TRACK 48V

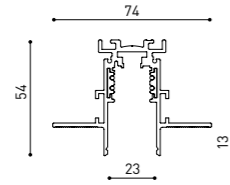
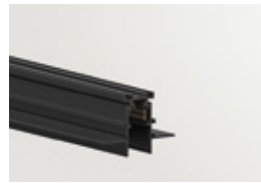

TRACK 48V TRIMLESS

TRACK 48V TRIMLESS 1m	A338-01-00-	WT	N
TRACK 48V TRIMLESS 2m	A338-02-00-	WT	N
TRACK 48V TRIMLESS 3m	A338-03-00-	WT	N
TRACK 48V TRIMLESS Corner 90° One Plane	A338-06-00-	WT	N
TRACK 48V TRIMLESS Corner 90° Two Planes	A338-07-00-	WT	N

RECOMMENDED FOR INSTALLATIONS WHERE THE PROFILE CAN BE INSTALLED BEFORE THE FALSE PLASTERBOARD CEILING (THICKNESS 12,5mm.)



TRACK 48V TRIMLESS Corner 90° One Plane

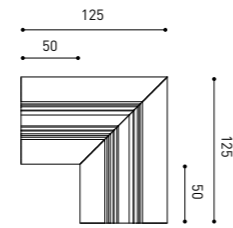

*Electrical connection not included

TRACK 48V TRIMLESS Corner 90° Two Planes

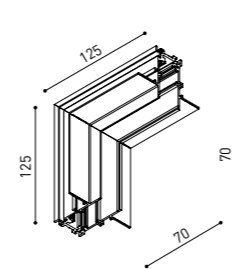

*Electrical connection not included

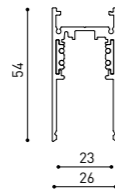

TRACK 48V SURFACE

TRACK 48V SURFACE 1m	A338-11-00-	WT	NT
TRACK 48V SURFACE 2m	A338-12-00-	WT	NT
TRACK 48V SURFACE 3m	A338-13-00-	WT	NT
TRACK 48V SURFACE Corner 90° One Plane	A338-14-00-	WT	NT



TRACK 48V SURFACE Corner 90° One Plane

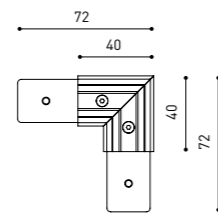

*Electrical connection not included

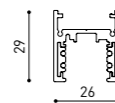

TRACK 48V SURFACE SHORT

TRACK 48V SURFACE SHORT 1m	A338-21-00-	WT	NT
TRACK 48V SURFACE SHORT 2m	A338-22-00-	WT	NT
TRACK 48V SURFACE SHORT 3m	A338-23-00-	WT	NT
TRACK 48V SURFACE SHORT Corner 90° One Plane	A338-24-00-	WT	NT



TRACK 48V SURFACE SHORT Corner 90° One Plane

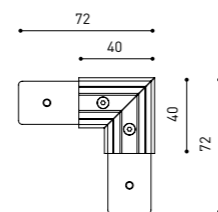

*Electrical connection not included

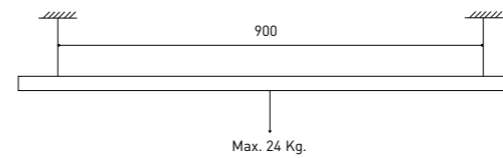

DROP VOLTAGE TABLE

POWER (W)	CABLE SECTION (mm ²)	CABLE LENGTH (m)			
		5	10	20	30
100	0,75	50	50	X	X
	1,5	50	50	40	25
150	0,75	40	15	X	X
	1,5	50	40	20	X

CONSTANT VOLTAGE LED POWER SUPPLY		P	V
0434-01-62		150W	48V
220 V - 240			

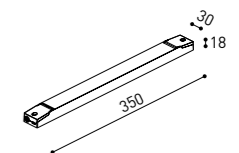

ACCESSORIES

TRACK 48V

ALL 48V TRACK

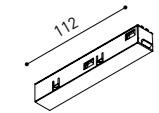

TRACK 48V Live-End Connector
A338-00-01- | W | N |

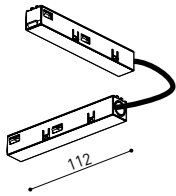

TRACK 48V Corner Connector
A338-00-12- | W | N |

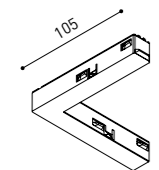

TRACK 48V Corner 90° Connector One Plane
A338-00-24- | W | N |
*Not suitable for trimless version

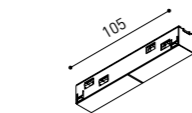

TRACK 48V Central Connector
A338-00-02- | W | N |

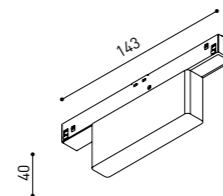

TRACK 48V Wireless Control
0434-01-31- | W | N | Casambi/AAG Stucchi App

TRIMLESS 48V



TRACK 48V TRIMLESS Short T-Bracket
A338-00-03



TRACK 48V Clamp for M6 ROD
A338-00-09
*See accessories quantities

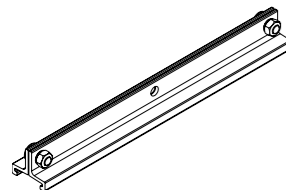

TRACK 48V TRIMLESS Long T-Bracket
A338-00-04



TRACK 48V Track Clamp
A338-00-10
*See accessories quantities

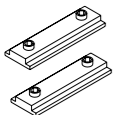

TRACK 48V TRIMLESS Straight Joiners (2 units)
A338-00-05- | WT | N |



TRACK 48V TRIMLESS Suspension Kit
A338-00-08
*See accessories quantities

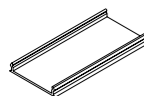

TRACK 48V TRIMLESS Plaster Installation Guard 1m
A338-00-21

*** SUGGESTED MOUNTING ACCESSORIES QUANTITIES**
1000mm - 2 Pcs.
2000mm - 3 Pcs.
3000mm - 4 Pcs.

SURFACE, SUSPENSION, SURFACE SHORT & SUSPENSION SHORT 48V

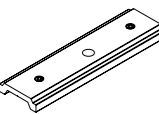

TRACK 48V SURFACE Straight Joiner
A338-00-11

COLOUR | N ■ RAL 9005 | W □ RAL 9016 | NT ■ RAL 9005 | WT □ RAL 9016 |

ACCESSORIES

TRACK 48V

SUSPENSION & SUSPENSION SHORT 48V

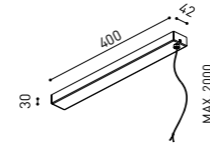

TRACK 48V Wired Power Supply Case
A338-00-25- | NT | WT | 150 W NO DIM
A338-00-26- | NT | WT | 150 W DIM
220 V ~ 240 V INCL

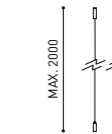

TRACK 48V SURFACE Suspension Kit (2 units)
A338-00-15- | NT | WT |

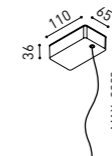

TRACK 48V SURFACE Suspension Feed Kit
A338-00-16- | N | W | NO DIM
A338-00-17- | N | W | DIM
*For remote power supply

SURFACE & SURFACE SHORT 48V

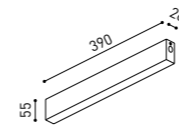

TRACK 48V Power Supply Case
A338-00-29- | NT | WT | 150 W
220 V ~ 240 V INCL *To be installed aside 48V Surface Tracks

WIRE TRIMLESS ACCESSORIES

FEED

MAINS TRIMLESS*

A023-00-01- | W | N | NO DIM

Mains Thick Trimless*

A023-00-02- | W | N | DIM

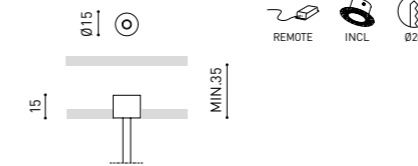

MAINS TRIMLESS

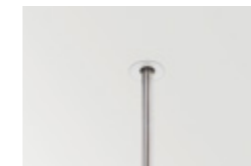

MAINS THICK TRIMLESS

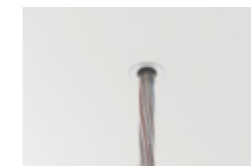

STEEL CABLE TRIMLESS

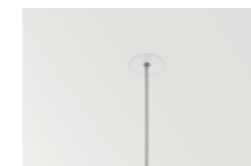

FASTENING

STEEL CABLE TRIMLESS*

A023-00-05- | W | N |

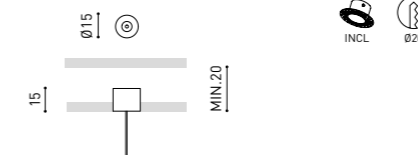

COLOUR | N ■ RAL 9005 | W □ RAL 9016 | NT ■ RAL 9005 | WT □ RAL 9016 |

* AS MANY PIECES AS NEEDED ACCORDING TO YOUR PRODUCT

TRIMLESS, SURFACE & SUSPENSION 48V



TRACK 48V TRIMLESS & SURFACE End
A338-00-06- | NT | WT |



TRACK 48V TRIMLESS & SURFACE End Feed
A338-00-07- | NT | WT |

SURFACE SHORT & SUSPENSION SHORT 48V



TRACK 48V SURFACE SHORT End
A338-00-18- | NT | WT |



TRACK 48V SURFACE SHORT End Feed
A338-00-19- | NT | WT |

LINE 1000

BLACK FOSTER MICRO 10

TOP

iO

FIT

PLUS

SIX

ZEN TUBE

SPIN

HOLLY

STICK 44

UNA GAMA A LA ALTURA DE SUS PRESTACIONES

Arkoslight ofrece una completa gama para su carril de bajo voltaje. Focos, luminarias suspendidas, módulos de luz difusa... la variedad de soluciones, formatos y tamaños de luminarias es amplísima para poder responder a las necesidades del interiorista, el arquitecto o el lighting desinger más exigente.

LINE 48V
—
500 / 1000 / 2000

10,5 / 21 / 42 W
2700 / 3000 / 4000 K
1500 / 6600 Lm
98° BEAM
43% LOR

BLACK FOSTER MICRO 48V
—
5 / 10

7 / 14 W
2700 / 3000 / 4000 K
775 / 1700 Lm
37° BEAM
87% LOR

TOP 48V
—
TOP MINI / TOP

6,5 W
2700 / 3000 K
610 / 640 Lm
20 / 30 / 56° BEAM
86 - 92 % LOR

iO 48V

4,5 W
2700 / 3000 K
485 / 505 Lm
20 / 30 / 56° BEAM
86 - 92 % LOR

FIT 48V
—
20 / 35 / 50

2,1 - 12 W
2700 / 3000 / 4000 K
127 - 1230 Lm
12 - 54° BEAM
80 - 88 % LOR

PLUS 48V
—
PLUS MINI / PLUS

6,5 / 18 W
2700 / 3000 / 4000 K
630 - 2030 Lm
10 - 41° / 12 - 51° BEAM
20 - 40 % LOR

SIX 48V
—
XS / S / M / L

4,5 - 24,5 W
2700 / 3000 / 4000 K
470 - 3000 Lm
17 - 38° BEAM
84 - 93 % LOR

ZEN TUBE 48V

12 / 17 / 23 W
2700 / 3000 K
1580 - 3190 Lm
16 / 24 / 42° BEAM
90% LOR

SPIN 48V

6,5 W
2700 / 3000 K
600 / 630 Lm
24 / 40° BEAM
84 / 86 % LOR

HOLLY 48V

2,1 W
2700 / 3000 K
190 / 210 Lm
19 / 38° BEAM
90 / 92 % LOR

STICK 48V
—
22 / 44 / 66

5,6 W
2700 / 3000 K
530 / 600 Lm
22 / 37 / 46° BEAM
81 - 84 % LOR

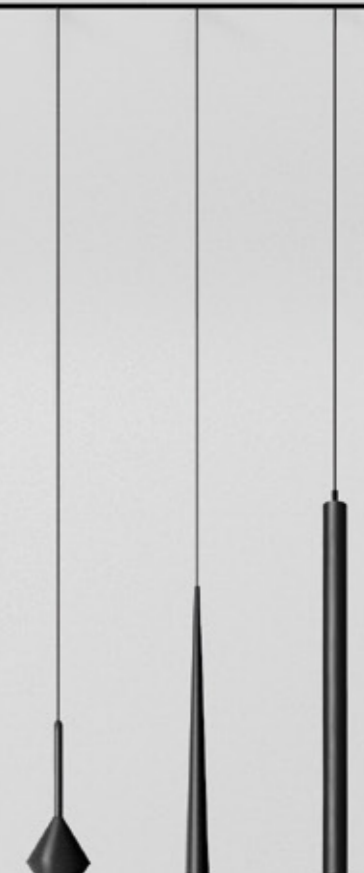



Private residence | Aurea arquitectos | Photography: Cuatli Photo Studio

48V SYSTEM SIX 48V



SIX L 48V	+RE	P	CCT	Beam	I	Flux	LOR
A329-0- Ⓞ -10- WT NT WTW NTW -S		24,5W	2700K	17°	700mA	2850Lm	93%
A329-0- Ⓞ -11- WT NT WTW NTW -S		24,5W	3000K	17°	700mA	2950Lm	93%
A329-0- Ⓞ -12- WT NT WTW NTW -S		24,5W	4000K	17°	700mA	3000Lm	93%
A329-0- Ⓞ -30- WT NT WTW NTW -S		24,5W	2700K	26°	700mA	2850Lm	93%
A329-0- Ⓞ -31- WT NT WTW NTW -S		24,5W	3000K	26°	700mA	2950Lm	93%
A329-0- Ⓞ -32- WT NT WTW NTW -S		24,5W	4000K	26°	700mA	3000Lm	93%
A329-0- Ⓞ -20- WT NT WTW NTW -S		24,5W	2700K	34°	700mA	2850Lm	90%
A329-0- Ⓞ -21- WT NT WTW NTW -S		24,5W	3000K	34°	700mA	2950Lm	90%
A329-0- Ⓞ -22- WT NT WTW NTW -S		24,5W	4000K	34°	700mA	3000Lm	90%

48 V | III | IP20 | CRI>90 | L80B10 >60.000h



Ⓞ	*OPTIONS
1	No DIM
2	DIM DALI

+RE	REF. ENDING	EXAMPLE
⌀	Track 48V	A3290110WT
-S	Track 48V Short	A3290110WT-S

OPTIONAL ACCESSORY

SIX L High Chromatic LED** ⓘ » 536

NOT SOLD SEPARATELY

FINISHING	Lamp	Adaptor
WT	WT <input type="checkbox"/>	N <input checked="" type="checkbox"/>
NT	NT <input checked="" type="checkbox"/>	N <input checked="" type="checkbox"/>
WTW	WT <input type="checkbox"/>	W <input type="checkbox"/>
NTW	NT <input checked="" type="checkbox"/>	W <input type="checkbox"/>

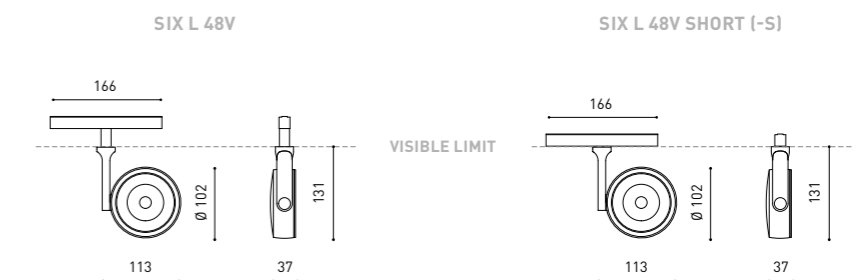

COLOUR | WT | NT | W | N | MATERIAL | AL | PC |

** ACCESSORY & COLOURS AFFECT THE LIGHTING PARAMETERS
+RE >> THE PRODUCTS FOR THE TRACK 48V SHORT, ADD "-S" AT THE END OF THE SALES REFERENCE (AFTER THE LETTERS WHICH INDICATE THE COLOUR OF THE PRODUCT).

ⓘ » PLEASE CONSULT



SIX M 48V	+RE	P	CCT	Beam	I	Flux	LOR
A330-0- Ⓞ -10- WT NT WTW NTW -S		17W	2700K	19°	500mA	2050Lm	93%
A330-0- Ⓞ -11- WT NT WTW NTW -S		17W	3000K	19°	500mA	2130Lm	93%
A330-0- Ⓞ -12- WT NT WTW NTW -S		17W	4000K	19°	500mA	2160Lm	93%
A330-0- Ⓞ -20- WT NT WTW NTW -S		17W	2700K	28°	500mA	2050Lm	91%
A330-0- Ⓞ -21- WT NT WTW NTW -S		17W	3000K	28°	500mA	2130Lm	91%
A330-0- Ⓞ -22- WT NT WTW NTW -S		17W	4000K	28°	500mA	2160Lm	91%
A330-0- Ⓞ -30- WT NT WTW NTW -S		17W	2700K	38°	500mA	2050Lm	93%
A330-0- Ⓞ -31- WT NT WTW NTW -S		17W	3000K	38°	500mA	2130Lm	93%
A330-0- Ⓞ -32- WT NT WTW NTW -S		17W	4000K	38°	500mA	2160Lm	93%

48 V | IP20 | CRI>90 | L80B10 >60.000h



SIX S 48V	+RE	P	CCT	Beam	I	Flux	LOR
A333-0- Ⓞ -10- WT NT WTW NTW -S		8,5W	2700K	17°	500mA	1030Lm	86%
A333-0- Ⓞ -11- WT NT WTW NTW -S		8,5W	3000K	17°	500mA	1070Lm	86%
A333-0- Ⓞ -12- WT NT WTW NTW -S		8,5W	4000K	17°	500mA	1100Lm	86%
A333-0- Ⓞ -20- WT NT WTW NTW -S		8,5W	2700K	24°	500mA	1030Lm	84%
A333-0- Ⓞ -21- WT NT WTW NTW -S		8,5W	3000K	24°	500mA	1070Lm	84%
A333-0- Ⓞ -22- WT NT WTW NTW -S		8,5W	4000K	24°	500mA	1100Lm	84%
A333-0- Ⓞ -30- WT NT WTW NTW -S		8,5W	2700K	34°	500mA	1030Lm	89%
A333-0- Ⓞ -31- WT NT WTW NTW -S		8,5W	3000K	34°	500mA	1070Lm	89%
A333-0- Ⓞ -32- WT NT WTW NTW -S		8,5W	4000K	34°	500mA	1100Lm	89%

48 V | IP20 | CRI>90 | L80B10 >60.000h



SIX XS 48V	+RE	P	CCT	Beam	I	Flux	LOR
A335-0- Ⓞ -10- WT NT WTW NTW -S		4,5W	2700K	17°	500mA	470Lm	90%
A335-0- Ⓞ -11- WT NT WTW NTW -S		4,5W	3000K	17°	500mA	500Lm	90%
A335-0- Ⓞ -12- WT NT WTW NTW -S		4,5W	4000K	17°	500mA	530Lm	90%
A335-0- Ⓞ -20- WT NT WTW NTW -S		4,5W	2700K	23°	500mA	470Lm	86%
A335-0- Ⓞ -21- WT NT WTW NTW -S		4,5W	3000K	23°	500mA	500Lm	86%
A335-0- Ⓞ -22- WT NT WTW NTW -S		4,5W	4000K	23°	500mA	530Lm	86%
A335-0- Ⓞ -30- WT NT WTW NTW -S		4,5W	2700K	34°	500mA	470Lm	88%
A335-0- Ⓞ -31- WT NT WTW NTW -S		4,5W	3000K	34°	500mA	500Lm	88%
A335-0- Ⓞ -32- WT NT WTW NTW -S		4,5W	4000K	34°	500mA	530Lm	88%

48 V | IP20 | CRI>90 | L80B10 >60.000h



SIX XS 48V Double	+RE	P	CCT	Beam	I	Flux	LOR
A335-1- Ⓞ -10- WT NT WTW NTW -S		9W	2700K	17°	500mA	2 X 470Lm	90%
A335-1- Ⓞ -11- WT NT WTW NTW -S		9W	3000K	17°	500mA	2 X 500Lm	90%
A335-1- Ⓞ -12- WT NT WTW NTW -S		9W	4000K	17°	500mA	2 X 530Lm	90%
A335-1- Ⓞ -20- WT NT WTW NTW -S		9W	2700K	23°	500mA	2 X 470Lm	86%
A335-1- Ⓞ -21- WT NT WTW NTW -S		9W	3000K	23°	500mA	2 X 500Lm	86%
A335-1- Ⓞ -22- WT NT WTW NTW -S		9W	4000K	23°	500mA	2 X 530Lm	86%
A335-1- Ⓞ -30- WT NT WTW NTW -S		9W	2700K	34°	500mA	2 X 470Lm	88%
A335-1- Ⓞ -31- WT NT WTW NTW -S		9W	3000K	34°	500mA	2 X 500Lm	88%
A335-1- Ⓞ -32- WT NT WTW NTW -S		9W	4000K	34°	500mA	2 X 530Lm	88%

48 V | IP20 | CRI>90 | L80B10 >60.000h



OPTIONAL ACCESSORIES

SIX M High Chromatic LED**	» 536
SIX S High Chromatic LED**	» 536

NOT SOLD SEPARATELY

Ⓞ *OPTIONS

1	No DIM
2	DIM DALI

+RE REF. ENDING EXAMPLE

∅	Track 48V	A3300110WT
-S	Track 48V Short	A3300110WT-S

OPTIONAL ACCESSORY

SIX XS High Chromatic LED**	» 536
-----------------------------	-------

NOT SOLD SEPARATELY

Ⓞ *OPTIONS

1	No DIM
2	DIM DALI

+RE REF. ENDING EXAMPLE

∅	Track 48V	A3350110WT
-S	Track 48V Short	A3350110WT-S

FINISHING	Lamp	Adaptor
WT	WT <input type="checkbox"/> N <input type="checkbox"/>	
NT	NT <input type="checkbox"/> N <input type="checkbox"/>	
WTW	WT <input type="checkbox"/> W <input type="checkbox"/>	
NTW	NT <input type="checkbox"/> W <input type="checkbox"/>	

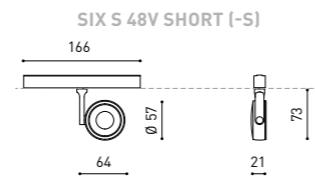
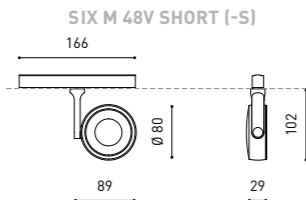
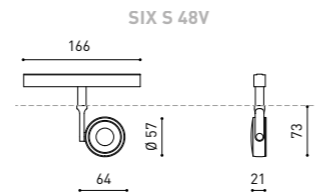
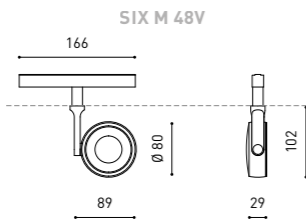

FINISHING	Lamp	Adaptor
WT	WT <input type="checkbox"/> N <input type="checkbox"/>	
NT	NT <input type="checkbox"/> N <input type="checkbox"/>	
WTW	WT <input type="checkbox"/> W <input type="checkbox"/>	
NTW	NT <input type="checkbox"/> W <input type="checkbox"/>	

SIX XS 48V

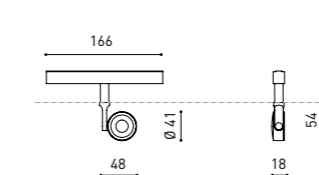

SIX XS 48V DOUBLE

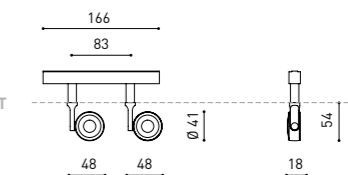

SIX XS 48V SHORT (-S)

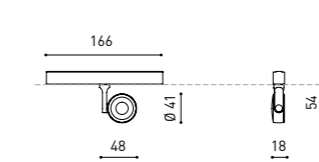

SIX XS 48V DOUBLE - SHORT (-S)

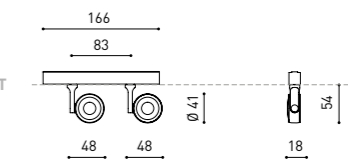

COLOUR | WT | NT | W | N | MATERIAL | AL | PC |

** ACCESSORY & COLOURS AFFECT THE LIGHTING PARAMETERS
+RE >> THE PRODUCTS FOR THE TRACK 48V SHORT, ADD "-S" AT THE END OF THE SALES REFERENCE (AFTER THE LETTERS WHICH INDICATE THE COLOUR OF THE PRODUCT).

» PLEASE CONSULT



COLOUR | WT | NT | W | N | MATERIAL | AL | PC |

** ACCESSORY & COLOURS AFFECT THE LIGHTING PARAMETERS
+RE >> THE PRODUCTS FOR THE TRACK 48V SHORT, ADD "-S" AT THE END OF THE SALES REFERENCE (AFTER THE LETTERS WHICH INDICATE THE COLOUR OF THE PRODUCT).

» PLEASE CONSULT



48V SYSTEM
FIT 48V



FIT 50 48V	+RE	P	CCT	Beam	I	Flux	LOR
A346-0- 00 -10- WT NT G WTW NTW GW -S		12W	2700K	15°	1050mA	1040Lm	85%
A346-0- 00 -11- WT NT G WTW NTW GW -S		12W	3000K	15°	1050mA	1120Lm	85%
A346-0- 00 -12- WT NT G WTW NTW GW -S		12W	4000K	15°	1050mA	1230Lm	85%
A346-0- 00 -20- WT NT G WTW NTW GW -S		12W	2700K	28°	1050mA	1040Lm	82%
A346-0- 00 -21- WT NT G WTW NTW GW -S		12W	3000K	28°	1050mA	1120Lm	82%
A346-0- 00 -22- WT NT G WTW NTW GW -S		12W	4000K	28°	1050mA	1230Lm	82%
A346-0- 00 -30- WT NT G WTW NTW GW -S		12W	2700K	47°	1050mA	1040Lm	80%
A346-0- 00 -31- WT NT G WTW NTW GW -S		12W	3000K	47°	1050mA	1120Lm	80%
A346-0- 00 -32- WT NT G WTW NTW GW -S		12W	4000K	47°	1050mA	1230Lm	80%

48V | III | IP20 | CRI>90 | L80B10 >60,000h



⊕	*OPTIONS
1	No DIM
2	DIM DALI

+RE	REF. ENDING	EXAMPLE
0	Track 48V	A3460110WT
-S	Track 48V Short	A3460110WT-S

FINISHING	Lamp	Adaptor
WT	WT □ N ■	
NT	NT ■ N ■	
G	G ■ N ■	
WTW	WT □ W □	
NTW	NT ■ W □	
GW	G ■ W □	

OPTIONAL ACCESSORY
FIT 50 Anti-glare Honeycomb Louver **
A346-00-00

NOT SOLD SEPARATELY

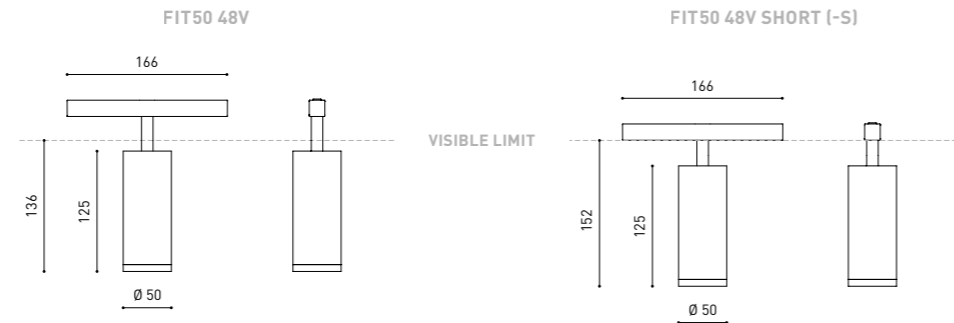

COLOUR | WT □ | NT ■ | G ■ | W □ | N ■ | MATERIAL | AL | PC |

** ACCESSORY AFFECTS THE LIGHTING PARAMETERS
+RE >> THE PRODUCTS FOR THE TRACK 48V SHORT, ADD "-S" AT THE END OF THE SALES REFERENCE (AFTER THE LETTERS WHICH INDICATE THE COLOUR OF THE PRODUCT). (()) >> PLEASE CONSULT





FIT 35 48V	+RE	P	CCT	Beam	I	Flux	LOR
A345-0- ∞ -10- WT NT G WTW NTW GW -S		5,5W	2700K	19°	500mA	590Lm	82%
A345-0- ∞ -11- WT NT G WTW NTW GW -S		5,5W	3000K	19°	500mA	630Lm	82%
A345-0- ∞ -12- WT NT G WTW NTW GW -S		5,5W	4000K	19°	500mA	700Lm	82%
A345-0- ∞ -20- WT NT G WTW NTW GW -S		5,5W	2700K	29°	500mA	590Lm	80%
A345-0- ∞ -21- WT NT G WTW NTW GW -S		5,5W	3000K	29°	500mA	630Lm	80%
A345-0- ∞ -22- WT NT G WTW NTW GW -S		5,5W	4000K	29°	500mA	700Lm	80%
A345-0- ∞ -30- WT NT G WTW NTW GW -S		5,5W	2700K	38°	500mA	590Lm	80%
A345-0- ∞ -31- WT NT G WTW NTW GW -S		5,5W	3000K	38°	500mA	630Lm	80%
A345-0- ∞ -32- WT NT G WTW NTW GW -S		5,5W	4000K	38°	500mA	700Lm	80%

48V | III | IP20 | CRI>90 | L80B10 >60.000h



∞	*OPTIONS
1	No DIM
2	DIM DALI

+RE	REF. ENDING	EXAMPLE
∅	Track 48V	A3450110WT
-S	Track 48V Short	A3450110WT-S

FINISHING	Lamp	Adaptor
WT	WT □ N ■	
NT	NT ■ N ■	
G	G ■ N ■	
WTW	WT □ W □	
NTW	NT ■ W □	
GW	G ■ W □	

OPTIONAL ACCESSORY
FIT 35 Anti-glare Honeycomb Louver **
 A345-00-00

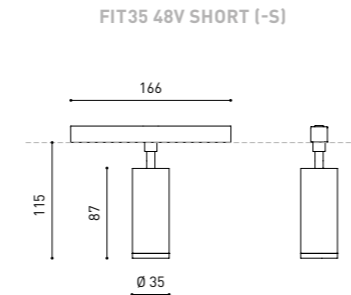
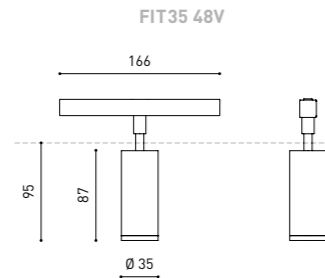

COLOUR | WT □ | NT ■ | G ■ | W □ | N ■ | MATERIAL | AL | PC |

** ACCESSORY AFFECTS THE LIGHTING PARAMETERS
 +RE >> THE PRODUCTS FOR THE TRACK 48V SHORT, ADD "-S" AT THE END OF THE SALES REFERENCE
 (AFTER THE LETTERS WHICH INDICATE THE COLOUR OF THE PRODUCT).

(((∞))) » PLEASE CONSULT



FIT 35 48V Double	+RE	P	CCT	Beam	I	Flux	LOR
A345-1- ∞ -10- WT NT G WTW NTW GW -S		11W	2700K	19°	500mA	2 x 590Lm	82%
A345-1- ∞ -11- WT NT G WTW NTW GW -S		11W	3000K	19°	500mA	2 x 630Lm	82%
A345-1- ∞ -12- WT NT G WTW NTW GW -S		11W	4000K	19°	500mA	2 x 700Lm	82%
A345-1- ∞ -20- WT NT G WTW NTW GW -S		11W	2700K	29°	500mA	2 x 590Lm	80%
A345-1- ∞ -21- WT NT G WTW NTW GW -S		11W	3000K	29°	500mA	2 x 630Lm	80%
A345-1- ∞ -22- WT NT G WTW NTW GW -S		11W	4000K	29°	500mA	2 x 700Lm	80%
A345-1- ∞ -30- WT NT G WTW NTW GW -S		11W	2700K	38°	500mA	2 x 590Lm	80%
A345-1- ∞ -31- WT NT G WTW NTW GW -S		11W	3000K	38°	500mA	2 x 630Lm	80%
A345-1- ∞ -32- WT NT G WTW NTW GW -S		11W	4000K	38°	500mA	2 x 700Lm	80%

48V | III | IP20 | CRI>90 | L80B10 >60.000h



∞	*OPTIONS
1	No DIM
2	DIM DALI

+RE	REF. ENDING	EXAMPLE
∅	Track 48V	A3451110WT
-S	Track 48V Short	A3451110WT-S

FINISHING	Lamp	Adaptor
WT	WT □ N ■	
NT	NT ■ N ■	
G	G ■ N ■	
WTW	WT □ W □	
NTW	NT ■ W □	
GW	G ■ W □	

OPTIONAL ACCESSORY
FIT 35 Anti-glare Honeycomb Louver **
 A345-00-00

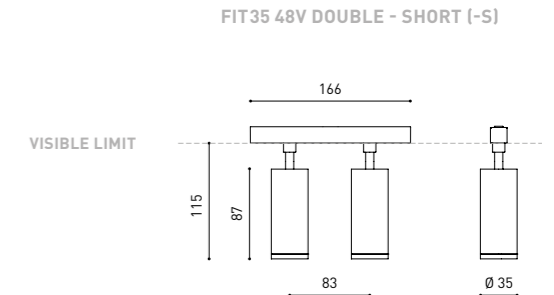
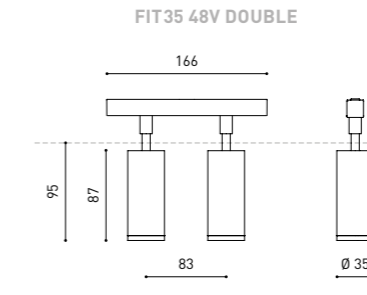

COLOUR | WT □ | NT ■ | G ■ | W □ | N ■ | MATERIAL | AL | PC |

** ACCESSORY AFFECTS THE LIGHTING PARAMETERS
 +RE >> THE PRODUCTS FOR THE TRACK 48V SHORT, ADD "-S" AT THE END OF THE SALES REFERENCE
 (AFTER THE LETTERS WHICH INDICATE THE COLOUR OF THE PRODUCT).

(((∞))) » PLEASE CONSULT



Bulthaup Sant Cugat, Barcelona (Spain) | Francesc Rifé Studio | Photography: Montse Capdevila

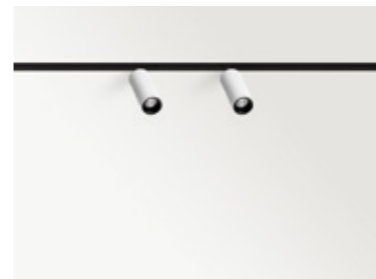

FIT20 48V	+RE	P	CCT	Beam	I	Flux	LOR
A344-0-Ⓞ-10- WT NT G WTW NTW GW -S		2,1W	2700K	12°	700mA	127Lm	87%
A344-0-Ⓞ-11- WT NT G WTW NTW GW -S		2,1W	3000K	12°	700mA	150Lm	87%
A344-0-Ⓞ-20- WT NT G WTW NTW GW -S		2,1W	2700K	30°	700mA	127Lm	88%
A344-0-Ⓞ-21- WT NT G WTW NTW GW -S		2,1W	3000K	30°	700mA	150Lm	88%
A344-0-Ⓞ-30- WT NT G WTW NTW GW -S		2,1W	2700K	54°	700mA	127Lm	81%
A344-0-Ⓞ-31- WT NT G WTW NTW GW -S		2,1W	3000K	54°	700mA	150Lm	81%

48 V | III | IP20 | CRI>90 | L80B10 >50.000h



FIT20 48V Double	+RE	P	CCT	Beam	I	Flux	LOR
A344-1-Ⓞ-10- WT NT G WTW NTW GW -S		4,2W	2700K	12°	700mA	2 x 127Lm	87%
A344-1-Ⓞ-11- WT NT G WTW NTW GW -S		4,2W	3000K	12°	700mA	2 x 150Lm	87%
A344-1-Ⓞ-20- WT NT G WTW NTW GW -S		4,2W	2700K	30°	700mA	2 x 127Lm	88%
A344-1-Ⓞ-21- WT NT G WTW NTW GW -S		4,2W	3000K	30°	700mA	2 x 150Lm	88%
A344-1-Ⓞ-30- WT NT G WTW NTW GW -S		4,2W	2700K	54°	700mA	2 x 127Lm	81%
A344-1-Ⓞ-31- WT NT G WTW NTW GW -S		4,2W	3000K	54°	700mA	2 x 150Lm	81%

48 V | III | IP20 | CRI>90 | L80B10 >50.000h



Ⓞ	*OPTIONS
1	No DIM
2	DIM DALI

+RE	REF. ENDING	EXAMPLE
Ⓞ	Track 48V	A3440110WT
-S	Track 48V Short	A3440110WT-S

FINISHING	Lamp	Adaptor
WT	WT □ N ■	
NT	NT ■ N ■	
G	G ■ N ■	
WTW	WT □ W □	
NTW	NT ■ W □	
GW	G ■ W □	

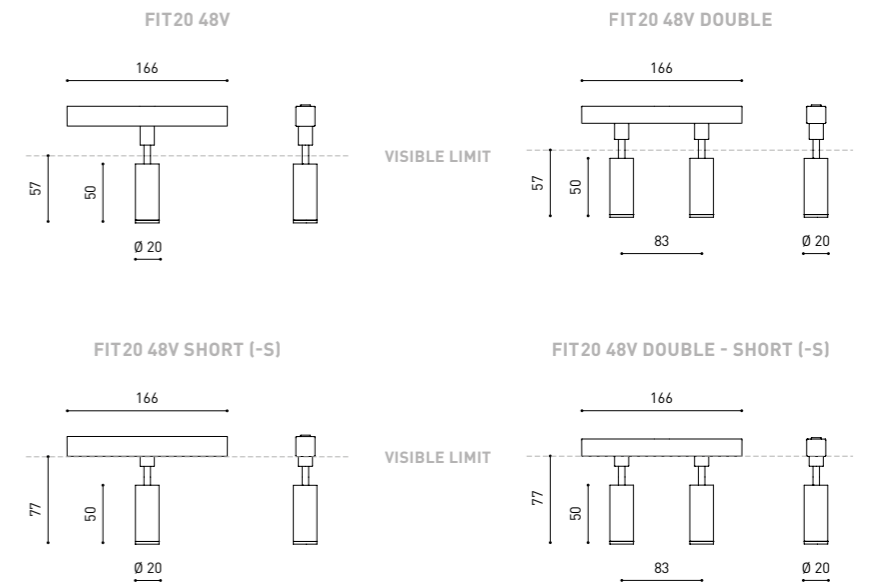

COLOUR | WT □ | NT ■ | G ■ | W □ | N ■ | MATERIAL | AL | PC |

+RE >> THE PRODUCTS FOR THE TRACK 48V SHORT, ADD "-S" AT THE END OF THE SALES REFERENCE (AFTER THE LETTERS WHICH INDICATE THE COLOUR OF THE PRODUCT).

Ⓞ » PLEASE CONSULT



Photography: Jesús Granada

48V SYSTEM PLUS 48V



OPTIONAL ACCESSORIES

plus High Chromatic LED** ⓘ » 536

plus MINI High Chromatic LED** ⓘ » 536

NOT SOLD SEPARATELY

FINISHING	Lamp	Adaptor
WT	WT <input type="checkbox"/> N <input type="checkbox"/>	N <input type="checkbox"/>
NT	NT <input type="checkbox"/> N <input type="checkbox"/>	N <input type="checkbox"/>
WTW	WT <input type="checkbox"/> W <input type="checkbox"/>	W <input type="checkbox"/>
NTW	NT <input type="checkbox"/> W <input type="checkbox"/>	W <input type="checkbox"/>

PLUS 48V	+RE	P	CCT	Beam	I	Flux	LOR
A323-00- ① -0- WT NT WTW NTW -S		18W	2700K	12°-51°	500mA	1920Lm	26-40%
A323-00- ① -1- WT NT WTW NTW -S		18W	3000K	12°-51°	500mA	2000Lm	26-40%
A323-00- ① -2- WT NT WTW NTW -S		18W	4000K	12°-51°	500mA	2030Lm	26-40%

48 V | IP20 | CRI>90 | L80B10 > 60.000h



PLUS Mini 48V	+RE	P	CCT	Beam	I	Flux	LOR
A326-00- ① -0- WT NT WTW NTW -S		6,5W	2700K	10°-41°	700mA	630Lm	20-40%
A326-00- ① -1- WT NT WTW NTW -S		6,5W	3000K	10°-41°	700mA	660Lm	20-40%
A326-00- ① -2- WT NT WTW NTW -S		6,5W	4000K	10°-41°	700mA	680Lm	20-40%

48 V | IP20 | CRI>90 | L80B10 > 60.000h



① *OPTIONS

1	No DIM
2	DIM DALI

+RE REF. ENDING EXAMPLE

Ø	Track 48V	A3230010WT
-S	Track 48V Short	A3230010WT-S

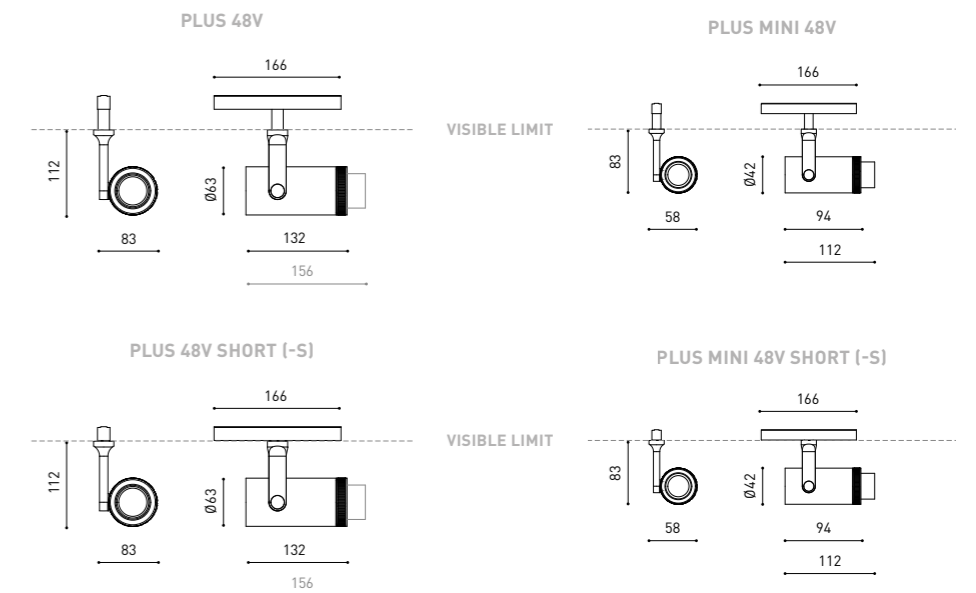

COLOUR | WT | NT | W | N | MATERIAL | AL | OPTICAL GLASS || OPTICAL PMMA |

** ACCESSORY AFFECTS THE LIGHTING PARAMETERS

+RE >> THE PRODUCTS FOR THE TRACK 48V SHORT, ADD "-S" AT THE END OF THE SALES REFERENCE (AFTER THE LETTERS WHICH INDICATE THE COLOUR OF THE PRODUCT).

ⓘ » PLEASE CONSULT

48V SYSTEM
iO 48V



iO 48V	+RE	P	CCT	Beam	I	Flux	LOR
A348-0- -10- WT NT WTW NTW -S		4,5W	2700K	20°	500mA	485Lm	92%
A348-0- -11- WT NT WTW NTW -S		4,5W	3000K	20°	500mA	505Lm	92%
A348-0- -20- WT NT WTW NTW -S		4,5W	2700K	30°	500mA	485Lm	89%
A348-0- -21- WT NT WTW NTW -S		4,5W	3000K	30°	500mA	505Lm	89%
A348-0- -30- WT NT WTW NTW -S		4,5W	2700K	56°	500mA	485Lm	86%
A348-0- -31- WT NT WTW NTW -S		4,5W	3000K	56°	500mA	505Lm	86%

48 V | IP20 | CRI>90 | L80B10 >60.000h



FINISHING	Lamp	Adaptor
WT	<input type="checkbox"/> WT	<input type="checkbox"/> N <input type="checkbox"/> ■
NT	<input type="checkbox"/> NT	<input type="checkbox"/> N <input type="checkbox"/> ■
WTW	<input type="checkbox"/> WT	<input type="checkbox"/> W <input type="checkbox"/> □
NTW	<input type="checkbox"/> NT	<input type="checkbox"/> W <input type="checkbox"/> □

*OPTIONS
1 No DIM
2 DIM DALI

+RE	REF. ENDING	EXAMPLE
0	Track 48V	A3480110WT
-S	Track 48V Short	A3480110WT-S

OPTIONAL ACCESSORIES

NOT SOLD SEPARATELY

iO Beam Mixer Diffuser** 0805-01-00



iO Anti-glare Honeycomb Louver** 0806-00-00 | WT | NT |



iO High Chromatic LED** » 536

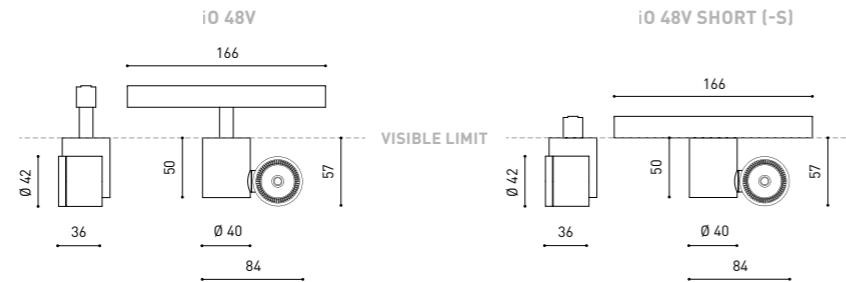

COLOUR | WT | NT | W | N ■ | MATERIAL | AL | PC |

** AFFECTS THE LIGHTING PARAMETERS
+RE >> THE PRODUCTS FOR THE TRACK 48V SHORT, ADD "-S" AT THE END OF THE SALES REFERENCE (AFTER THE LETTERS WHICH INDICATE THE COLOUR OF THE PRODUCT).

» PLEASE CONSULT



Casa Cruz, Valencia (Spain) | Rubén Muedra - Estudio de Arquitectura | Photography: Adrián Mera Maroto



48V SYSTEM ZEN TUBE 48V



		+RE	P	CCT	I	Flux	LOR
ZEN TUBE 48V 1	A341-11- 00 -0- WT NT WTW NTW -S	12W	2700K	350mA	1580Lm	90%	
	A341-11- 00 -1- WT NT WTW NTW -S	12W	3000K	350mA	1640Lm	90%	
ZEN TUBE 48V 2	A341-12- 00 -0- WT NT WTW NTW -S	17W	2700K	500mA	2130Lm	90%	
	A341-12- 00 -1- WT NT WTW NTW -S	17W	3000K	500mA	2220Lm	90%	
ZEN TUBE 48V 3	A341-13- 00 -0- WT NT WTW NTW -S	23W	2700K	700mA	3070Lm	90%	
	A341-13- 00 -1- WT NT WTW NTW -S	23W	3000K	700mA	3190Lm	90%	
DALI	A341-23- 00 -0- WT NT WTW NTW -S	23W	2700K	700mA	3070Lm	90%	
	A341-23- 00 -1- WT NT WTW NTW -S	23W	3000K	700mA	3190Lm	90%	

48V | IP20 | CRI>90 | L80B10 >60,000h

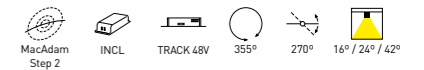

00	BEAM OPTIONS
1	16°
2	24°
3	42°

+RE	REF. ENDING	EXAMPLE
0	Track 48V	A3411110WT
-S	Track 48V Short	A3411110WT-S

FINISHING	Lamp	Adaptor
WT	WT □	N ■
NT	NT ■	N ■
WTW	WT □	W □
NTW	NT ■	W □

ZEN TUBE 48V

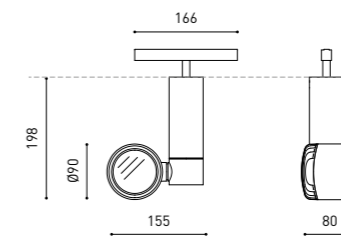

VISIBLE LIMIT

ZEN TUBE 48V SHORT (-S)

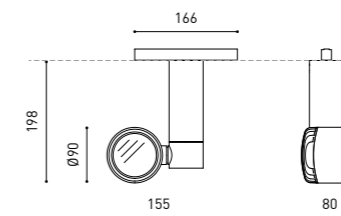

VISIBLE LIMIT

OPTIONAL ACCESSORIES

NOT SOLD SEPARATELY

ZEN Anti-glare Honeycomb Louver * 0702-02-00

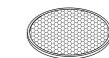

ZEN Elliptical Refractor * 0700-08-00



ZEN Beam Mixer Diffuser* 0805-02-00



ZEN High Chromatic LED*

COLOUR | WT □ | NT ■ | W □ | N ■ |

MATERIAL | AL | GL-TRANS |

* AFFECTS THE LIGHTING PARAMETERS

+RE >> THE PRODUCTS FOR THE TRACK 48V SHORT, ADD "-S" AT THE END OF THE SALES REFERENCE (AFTER THE LETTERS WHICH INDICATE THE COLOUR OF THE PRODUCT).

» PLEASE CONSULT

48V SYSTEM
TOP 48V



TOP 48V	+RE	P	CCT	Beam	I	Flux	LOR
A339-0- Ⓞ -10- WT NT WTW NTW -S		6,5W	2700K	20°	700mA	610Lm	92%
A339-0- Ⓞ -11- WT NT WTW NTW -S		6,5W	3000K	20°	700mA	640Lm	92%
A339-0- Ⓞ -20- WT NT WTW NTW -S		6,5W	2700K	30°	700mA	610Lm	89%
A339-0- Ⓞ -21- WT NT WTW NTW -S		6,5W	3000K	30°	700mA	640Lm	89%
A339-0- Ⓞ -30- WT NT WTW NTW -S		6,5W	2700K	56°	700mA	610Lm	86%
A339-0- Ⓞ -31- WT NT WTW NTW -S		6,5W	3000K	56°	700mA	640Lm	86%

48V | III | IP20 | CRI>90 | L80B10 >60.000h



FINISHING	Lamp	Adaptor
WT	WT □ N ■	
NT	NT ■ N ■	
WTW	WT □ W □	
NTW	NT ■ W □	

Ⓞ	*OPTIONS
1	No DIM
2	DIM DALI

+RE	REF. ENDING	EXAMPLE
∅	Track 48V	A3390110WT
-S	Track 48V Short	A3390110WT-S



TOP Mini 48V	+RE	P	CCT	Beam	I	Flux	LOR
A340-0- Ⓞ -10- WT NT WTW NTW -S		6,5W	2700K	20°	700mA	610Lm	92%
A340-0- Ⓞ -11- WT NT WTW NTW -S		6,5W	3000K	20°	700mA	640Lm	92%
A340-0- Ⓞ -20- WT NT WTW NTW -S		6,5W	2700K	30°	700mA	610Lm	89%
A340-0- Ⓞ -21- WT NT WTW NTW -S		6,5W	3000K	30°	700mA	640Lm	89%
A340-0- Ⓞ -30- WT NT WTW NTW -S		6,5W	2700K	56°	700mA	610Lm	86%
A340-0- Ⓞ -31- WT NT WTW NTW -S		6,5W	3000K	56°	700mA	640Lm	86%

48V | III | IP20 | CRI>90 | L80B10 >60.000h



FINISHING	Lamp	Adaptor
WT	WT □ N ■	
NT	NT ■ N ■	
WTW	WT □ W □	
NTW	NT ■ W □	

Ⓞ	*OPTIONS
1	No DIM
2	DIM DALI

+RE	REF. ENDING	EXAMPLE
∅	Track 48V	A3400110WT
-S	Track 48V Short	A3400110WT-S

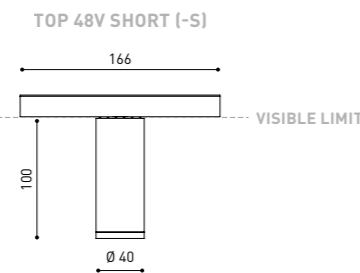
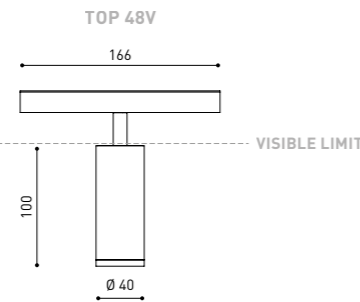

OPTIONAL ACCESSORIES
NOT SOLD SEPARATELY

TOP Beam Mixer Diffuser** 0805-01-00



top Anti-glare Honeycomb Louver** 0807-00-00 | WT | NT |



TOP High Chromatic LED** ⓘ » 536

COLOUR | WT □ | NT ■ | W □ | N ■ | MATERIAL | AL | PC |

** AFFECTS THE LIGHTING PARAMETERS
+RE >> THE PRODUCTS FOR THE TRACK 48V SHORT, ADD "-S" AT THE END OF THE SALES REFERENCE
(AFTER THE LETTERS WHICH INDICATE THE COLOUR OF THE PRODUCT).

ⓘ » PLEASE CONSULT

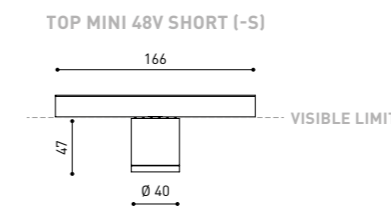
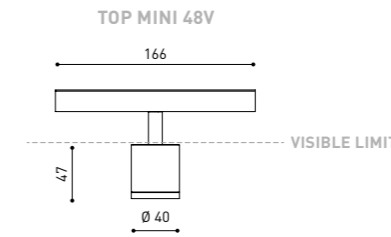

OPTIONAL ACCESSORIES
NOT SOLD SEPARATELY

TOP Beam Mixer Diffuser** 0805-01-00



top Anti-glare Honeycomb Louver** 0807-00-00 | WT | NT |



TOP High Chromatic LED** ⓘ » 536

COLOUR | WT □ | NT ■ | W □ | N ■ | MATERIAL | AL | PC |

** AFFECTS THE LIGHTING PARAMETERS
+RE >> THE PRODUCTS FOR THE TRACK 48V SHORT, ADD "-S" AT THE END OF THE SALES REFERENCE
(AFTER THE LETTERS WHICH INDICATE THE COLOUR OF THE PRODUCT).

ⓘ » PLEASE CONSULT



48V SYSTEM LINE 48V



		P	CCT	I	Flux	LOR
LINE 500 48V	A376-10- Ⓞ -0- N W**	10,5W	2700K	350mA	1500Lm	43%
	A376-10- Ⓞ -1- N W**	10,5W	3000K	350mA	1600Lm	43%
	A376-10- Ⓞ -2- N W**	10,5W	4000K	350mA	1650Lm	43%
LINE 1000 48V	A376-20- Ⓞ -0- N W**	21W	2700K	700mA	3000Lm	43%
	A376-20- Ⓞ -1- N W**	21W	3000K	700mA	3200Lm	43%
	A376-20- Ⓞ -2- N W**	21W	4000K	700mA	3300Lm	43%
LINE 2000 48V	A376-30- Ⓞ -0- N W**	42W	2700K	700mA	6000Lm	43%
	A376-30- Ⓞ -1- N W**	42W	3000K	700mA	6400Lm	43%
	A376-30- Ⓞ -2- N W**	42W	4000K	700mA	6600Lm	43%

48V | III IP20 | CRI>90 | L80B10 >60.000h



Ⓞ *OPTIONS

1	No DIM
2	DIM DALI

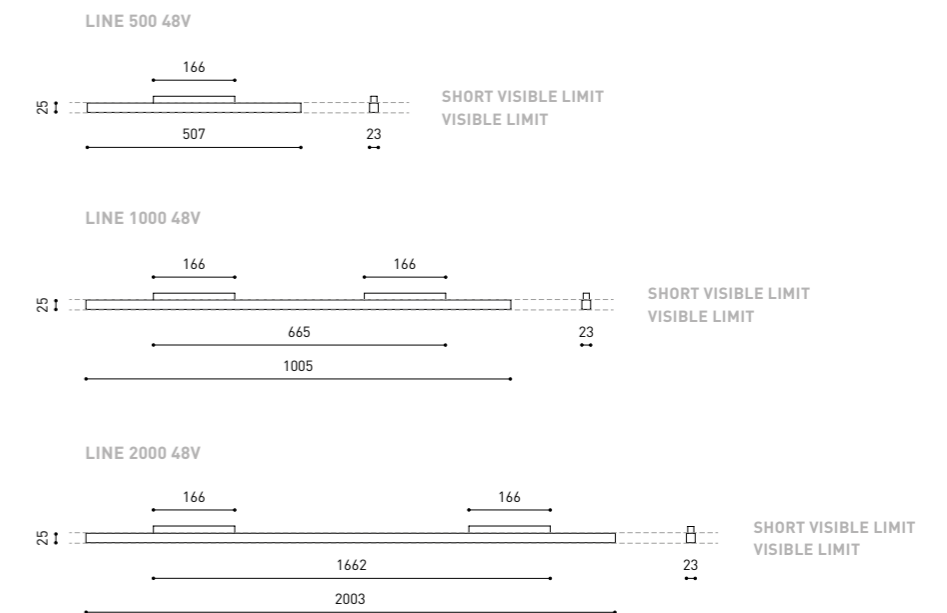

COLOUR | N ■ | W □ | MATERIAL | AL | PC |

** NOT SUGGESTED FOR TRACK 48V SHORT

☎️ » PLEASE CONSULT

48V SYSTEM

BLACK FOSTER MICRO 48V



Templeton Architecture | Photography: Rory Gardiner



		P	CCT	I	Flux	LOR
BLACK FOSTER Micro 48V 5	A416-20- 0-0- N	7W	2700K	500mA	775Lm	87%
	A416-20- 0-1- N	7W	3000K	500mA	800Lm	87%
	A416-20- 0-2- N	7W	4000K	500mA	850Lm	87%

48 V | III IP20 | CRI>90 | L90B10 >60.000h

MacAdam Step 3 | OPTIONS* | INCL | TRACK 48V | 37°

		P	CCT	I	Flux	LOR
BLACK FOSTER Micro 48V 10	A416-50- 0-0- N	14W	2700K	500mA	1550Lm	87%
	A416-50- 0-1- N	14W	3000K	500mA	1600Lm	87%
	A416-50- 0-2- N	14W	4000K	500mA	1700Lm	87%

48 V | III IP20 | CRI>90 | L90B10 >60.000h

MacAdam Step 3 | OPTIONS* | INCL | TRACK 48V | 37°

Ⓞ OPTIONS*

1	No DIM
2	DIM DALI

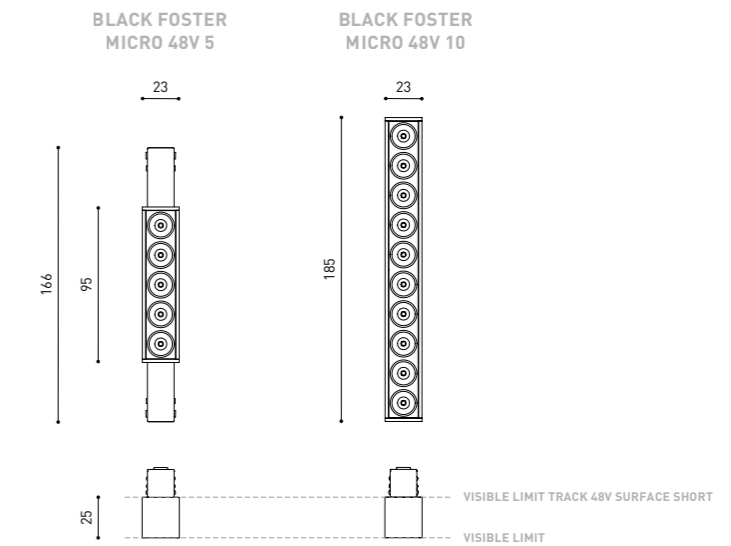

COLOUR | N ■ | MATERIAL | AL | ABS+PC

» PLEASE CONSULT

48V SYSTEM
STICK 48V



STICK 48V	P	CCT	Beam	I	Flux	LOR
A40- ○ - ○ - ○ - ○ -10- WT NT MG WTW NTW MGW	5,6W	2700K	22°	500mA	530Lm	84%
A40- ○ - ○ - ○ - ○ -11- WT NT MG WTW NTW MGW	5,6W	3000K	22°	500mA	600Lm	84%
A40- ○ - ○ - ○ - ○ -20- WT NT MG WTW NTW MGW	5,6W	2700K	37°	500mA	530Lm	82%
A40- ○ - ○ - ○ - ○ -21- WT NT MG WTW NTW MGW	5,6W	3000K	37°	500mA	600Lm	82%
A40- ○ - ○ - ○ - ○ -30- WT NT MG WTW NTW MGW	5,6W	2700K	46°	500mA	530Lm	81%
A40- ○ - ○ - ○ - ○ -31- WT NT MG WTW NTW MGW	5,6W	3000K	46°	500mA	600Lm	81%

48 V | IP20 | CRI>90 | L80B10 >60,000h



○	STICK LENGTH
7	STICK 22 220 mm
8	STICK 44 440 mm
9	STICK 66 660 mm

○	CORD LENGHT-L
0	2 m
2	5 m

○	OPTIONS*
1	No DIM
2	DIM DALI

OPTIONAL ACCESSORY

Cord Accessory

0223-00-00- | N |

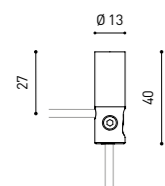

FINISHING	Lamp	Adaptor
WT	WT □ N ■	
NT	NT ■ N ■	
MG	MG ■ N ■	
WTW	WT □ W □	
NTW	NT ■ W □	
MGW	MG ■ W □	

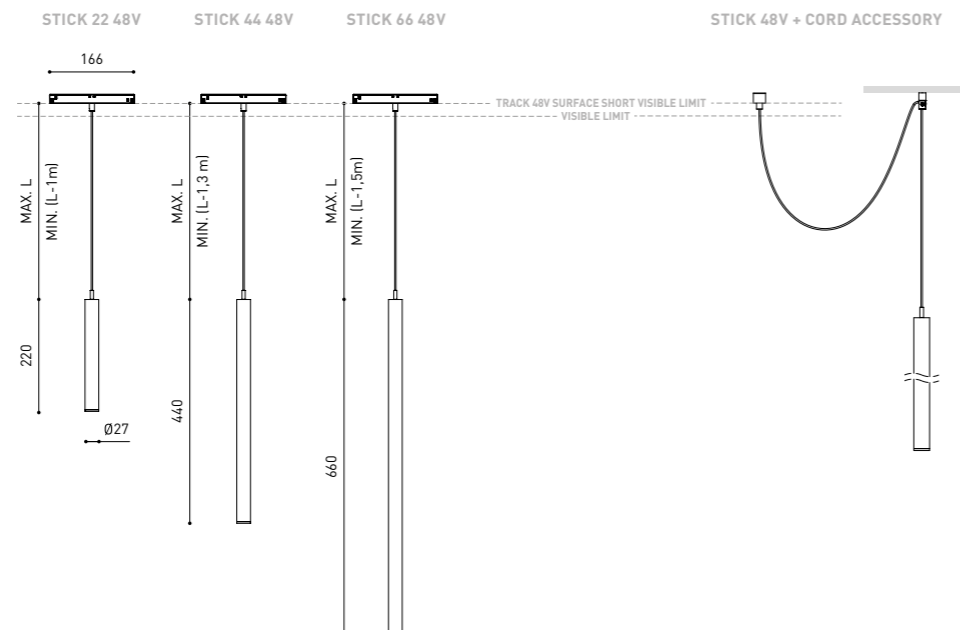

COLOUR | WT □ | NT ■ | MG ■ | W □ | N ■ | MATERIAL | AL | ABS+PC |

PLEASE CONSULT





Arkostight Stand, EuroLuce 2019, Milano (Italy) | Francese Rifé Studio | Photography: Alfonso Calza

48V SYSTEM HOLLY 48V



HOLLY 48V	P	CCT	Beam	I	Flux	LOR
A349- 00 -1-00- WT NT MC MG WTW NTW MCW MGW	2,1W	2700K	19°	700mA	190Lm	90%
A349- 00 -1-01- WT NT MC MG WTW NTW MCW MGW	2,1W	3000K	19°	700mA	210Lm	90%
A349- 00 -1-10- WT NT MC MG WTW NTW MCW MGW	2,1W	2700K	38°	700mA	190Lm	92%
A349- 00 -1-11- WT NT MC MG WTW NTW MCW MGW	2,1W	3000K	38°	700mA	210Lm	92%
A349- 00 -2-00- WT NT MC MG WTW NTW MCW MGW	2,1W	2700K	19°	700mA	190Lm	90%
A349- 00 -2-01- WT NT MC MG WTW NTW MCW MGW	2,1W	3000K	19°	700mA	210Lm	90%
A349- 00 -2-10- WT NT MC MG WTW NTW MCW MGW	2,1W	2700K	38°	700mA	190Lm	92%
A349- 00 -2-11- WT NT MC MG WTW NTW MCW MGW	2,1W	3000K	38°	700mA	210Lm	92%

48 V | IP20 | CRI>90 | L80B10 >60.000h



00	SUSPENSION DISTANCE
0	2 m
1	3 m
2	5 m

ADJUSTMENT RANGE 2m

OPTIONAL ACCESSORY

Cord Accessory

0223-00-00- | W | N |

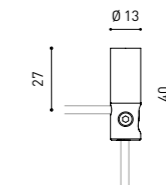

FINISHING	Lamp	Adaptor	Cord
WT	WT <input type="checkbox"/>	N <input type="checkbox"/>	W <input type="checkbox"/>
NT	NT <input type="checkbox"/>	N <input type="checkbox"/>	N <input type="checkbox"/>
MC	MC <input type="checkbox"/>	N <input type="checkbox"/>	N <input type="checkbox"/>
MG	MG <input type="checkbox"/>	N <input type="checkbox"/>	N <input type="checkbox"/>
WTW	WT <input type="checkbox"/>	W <input type="checkbox"/>	W <input type="checkbox"/>
NTW	NT <input type="checkbox"/>	W <input type="checkbox"/>	N <input type="checkbox"/>
MCW	MC <input type="checkbox"/>	W <input type="checkbox"/>	W <input type="checkbox"/>
MGW	MG <input type="checkbox"/>	W <input type="checkbox"/>	W <input type="checkbox"/>

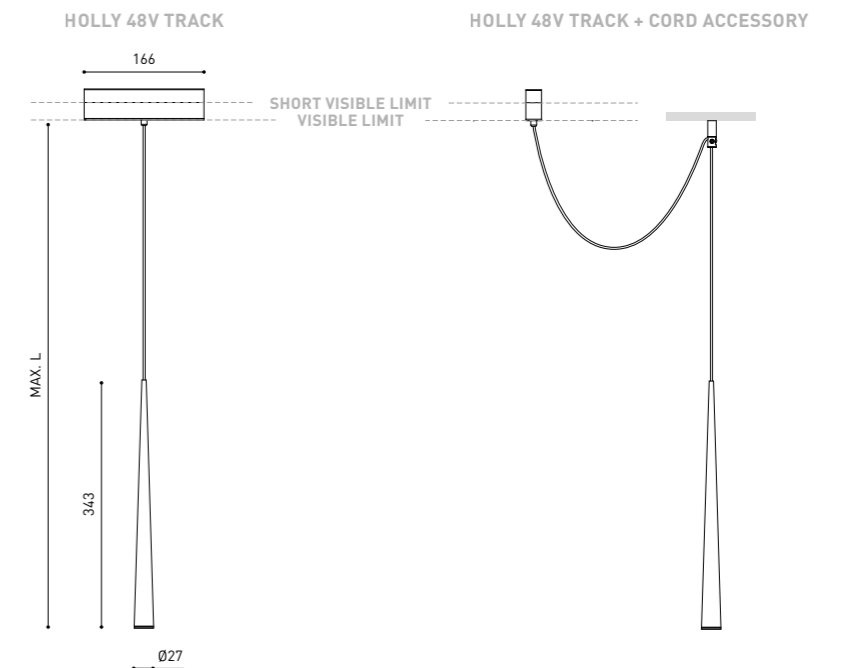

COLOUR | WT | NT | MC | MG | W | N | MATERIAL | AL | ABS |

» PLEASE CONSULT



48V SYSTEM SPIN 48V



SPIN 48V		P	CCT	Beam	I	Flux	LOR
A350-Ⓞ-1-00-	WT NT MC MG WTW NTW MCW MGW	6,5W	2700K	24°	700mA	600Lm	86%
A350-Ⓞ-1-01-	WT NT MC MG WTW NTW MCW MGW	6,5W	3000K	24°	700mA	630Lm	86%
A350-Ⓞ-1-10-	WT NT MC MG WTW NTW MCW MGW	6,5W	2700K	40°	700mA	600Lm	84%
A350-Ⓞ-1-11-	WT NT MC MG WTW NTW MCW MGW	6,5W	3000K	40°	700mA	630Lm	84%
A350-Ⓞ-2-00-	WT NT MC MG WTW NTW MCW MGW	6,5W	2700K	24°	700mA	600Lm	86%
A350-Ⓞ-2-01-	WT NT MC MG WTW NTW MCW MGW	6,5W	3000K	24°	700mA	630Lm	86%
A350-Ⓞ-2-10-	WT NT MC MG WTW NTW MCW MGW	6,5W	2700K	40°	700mA	600Lm	84%
A350-Ⓞ-2-11-	WT NT MC MG WTW NTW MCW MGW	6,5W	3000K	40°	700mA	630Lm	84%

48 V | IP20 | CRI>90 | L80B10 >60.000h



Ⓞ	SUSPENSION DISTANCE
0	2 m
1	3 m
2	5 m

ADJUSTMENT RANGE 2m

OPTIONAL ACCESSORY

Cord Accessory

0223-00-00- | W | N |

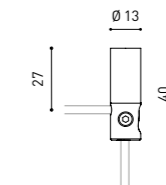



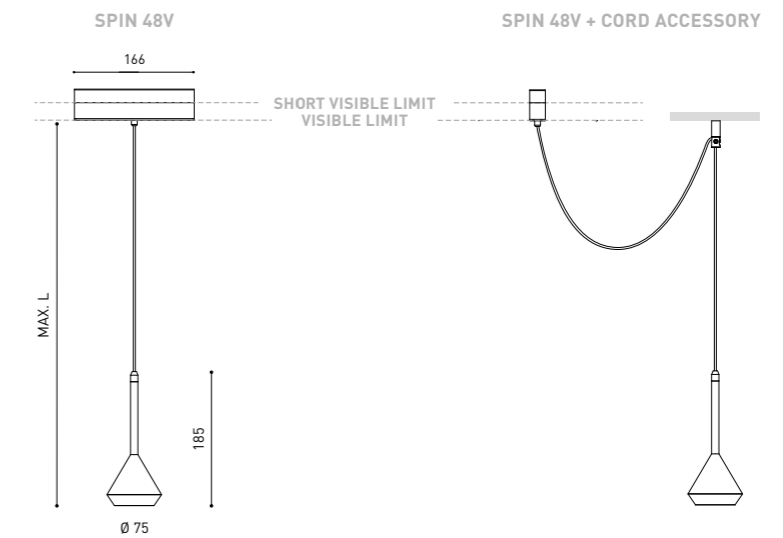















FINISHING	Lamp	Adaptor	Cord
WT			
NT			
MC			
MG			
WTW			
NTW			
MCW			
MGW			

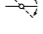

COLOUR | WT | NT | MC | MG | W | N | MATERIAL | AL | PMMA |

» PLEASE CONSULT

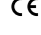
Glosario

P	Potencia		Clase III
CCT	Temperatura de color		Estabilidad cromática: Pasos MacAdam
I	Intensidad de corriente		Regulable
Flux	Flujo Luminico		Equipo no incluido
L	Longitud (en mm).		Equipo electrónico incluido
AL	Aluminio		Lente refractora elíptica
PC	Policarbonato		Difusor homogeneizador del haz de luz
ABS	Acrilonitrilo Butadieno Estireno		Difusor
LOR	<i>Lumen Output Ratio</i> . Relación entre el flujo de salida de la luminaria y el flujo de salida de la fuente de luz		Tipo de carril
IPXX	Índice de estanqueidad		Control por bluetooth
CRI	Índice de reproducción cromática		Tipo de instalación y dirección del haz de luz
GL	Cristal		Confort visual. UGR (<i>Unified Glare Rating</i>)
PMMA	Polimetilmetacrilato		Fabricado en
TRANS	Transparente		Cristal óptico
	Lámpara LED		Ángulo de basculación
48V	Tensión de alimentación 48vdc		Reflector
	Marcado CE		Ángulo de giro
	Certificado ENEC		

Colores

Los valores de iluminación indicados para cada código de referencia corresponden a los resultados obtenidos en los ensayos realizados sobre el primer color mencionado de la lista.

	N Negro mate = RAL 9005
	NT Negro texturizado = RAL 9005
	W Blanco = RAL 9016
	WT Blanco texturizado = RAL 9016
	MG Oro Metalizado*
	MC Cobre Metalizado*

*RAL no disponible. Pintura con nanopartículas metálicas.

Special LED

FOR COMMERCIAL PRODUCT SHOWCASING

Arkoslight ofrece en algunos de sus productos la posibilidad de dotarlos de un LED especial para iluminación orientada a la promoción visual de bienes y productos con finalidad comercial.

Se trata de un LED de alta cromaticidad que persigue destacar los tonos que favorecen la percepción psicológica positiva del objeto iluminado.

Esta fuente de luz LED especial ofrece una paleta de colores más atractiva e intensa, por encima de lo que lo hace un LED convencional. Esto se consigue gracias a la configuración del LED bajo un "parámetro especial de saturación" que consigue que los colores y la textura de los objetos se muestren más atractivos dentro del espectro de luz visible. Para ello se selecciona, en cada caso, el COB pertinente, con su recubrimiento específico de fósforo.

ARKOSLIGHT®

Calle N · Pol. Ind. EL OLIVERAL
46394 Ribarroja del Turia · Valencia (Spain)
Tel. +34 961 667 207 · Fax +34 961 667 054
info@arkoslight.com · www.arkoslight.com
France: +33 182 885 200 · Italia: +39 02 9475 0007
Deutschland: +49 22 182 829 313





LIGHT&LIFE
— DESDE 1984 —